

DASH NO.	M CODE	MADE FROM
----------	--------	-----------

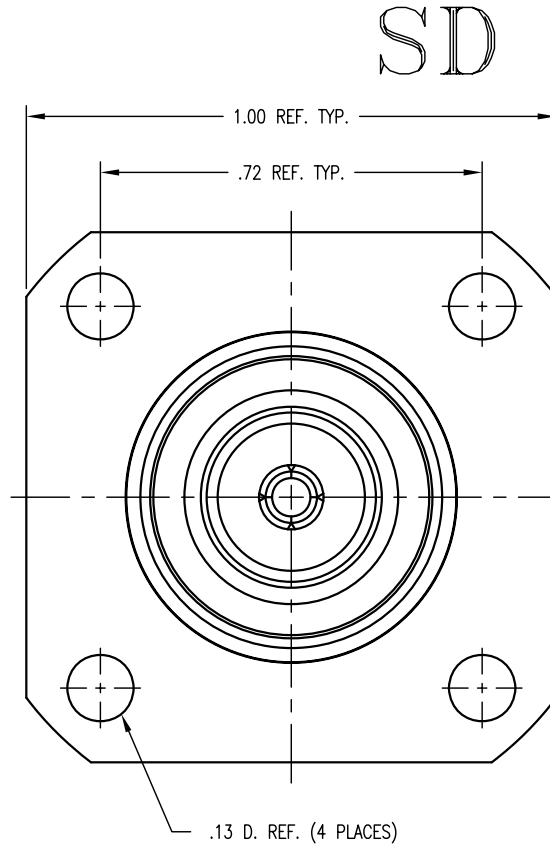
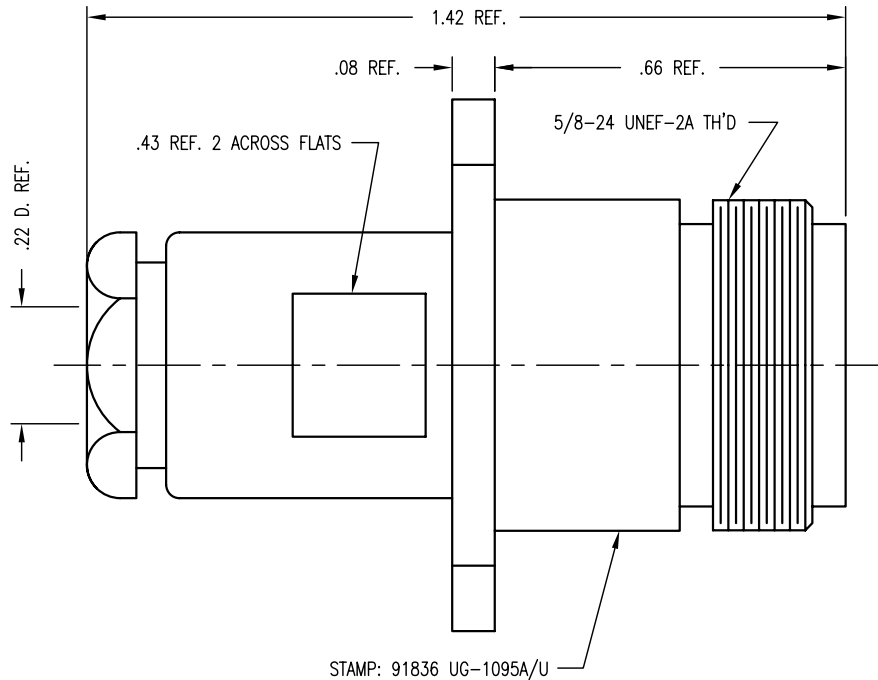

SD

SD

UG-1095B/U

REVISIONS

ISSUE	CHANGES
8	CN 37285 D REDRAWN KH 03/11/97
9	CN 37388 C MRM 07/22/97
M	REVISED PER ER17519 GGR 08/10/2009

G1095BC

THIS DRAWING, THE DESIGNS AND IDEAS EMBODIED IN THE DEVICE TO WHICH IT RELATES, AND THE METHOD OF PRODUCING THE DEVICE, ARE THE PROPERTY OF WINCHESTER ELECTRONICS CORPORATION AND SHALL NOT BE EMPLOYED, COPIED, OR DISCLOSED TO ANYONE, IN ANY MANNER WITHOUT THE CONSENT OF WINCHESTER ELECTRONICS CORPORATION.

SCALE 4:1

APPROX SURFACE AREA

KN-17-06

USED ON

REF:

JACK, PANEL, N

DRAWN	MJB	DATE	03/04/86
-------	-----	------	----------

DESIGN	MJB	DATE	03/04/86
--------	-----	------	----------

APPR.		DATE	
-------	--	------	--



UG-1095B/U

NOTES:

- FOR USE WITH RG-58, 142 & 223 /U CABLES.
- FOR CABLING INSTRUCTIONS SEE CP-1015.
- MATERIALS:
INSULATOR: TEFLON, ASTM-D-4894
GASKET: SIL. RUB., ZZ-R-765
CENTER CONTACT: BER. COP., ASTM-B-196
ALL OTHER METAL PARTS: BRASS, ASTM-B16
- FINISHES:
CENTER CONTACT: HARD GOLD PLT. PER MIL-G-45204
ALL OTHER METAL PARTS: SILVER PLT. PER QQ-S-365
- ELECTRICAL CHARACTERISTICS:
NOMINAL IMPEDANCE: 50 OHMS
VOLTAGE RATING: 1000 VRMS
FREQUENCY RANGE: DC TO 11 GHz